

**PRODUCT DEFINITION:**

Acoustic panel with grooves on wieved face and holes at back side. Soundtex black glass tissue applied to back face. Various color options available on all visible surfaces. Used for interior applicants in general building and civil engineering structures.

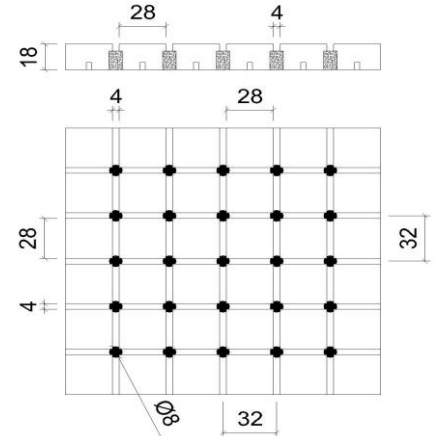
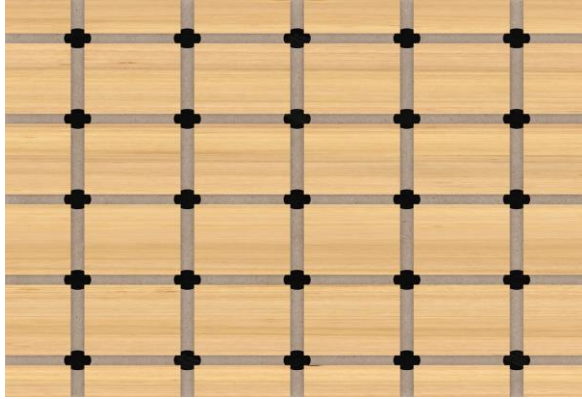

FREQUENCY(HZ)		100	125	160	200	250	315	400	500	630	800	1000	1250	1600	2000	2500	3150	4000	5000
SOUND ABSORPTION COEFFICIENT	Plenum 200mm	0,31	0,37	0,35	0,37	0,39	0,41	0,41	0,44	0,41	0,42	0,38	0,41	0,38	0,35	0,35	0,38	0,43	0,48
	Plenum 63mm	0,32	0,40	0,42	0,42	0,44	0,43	0,45	0,48	0,43	0,44	0,42	0,39	0,36	0,36	0,36	0,39	0,40	0,48

**ACOUSTIC FEATURES:**

Distance Between Grooves (mm)	28
Width Of Groove (mm)	4
Depth Of Groove (mm)	6
Diameter Of Hole (mm)	10
Pitch Of Hole (mm)	32x32
Depth Of Hole (mm)	15
Perforated Area (%)	4

**ACOUSTIC VALUES**

<b>Mounting Depth</b>	<b>NRC</b>	<b>Euro Class</b>
Plenum 63 mm	0,45	D
Plenum 200 mm	0,40	D

Mineral Wool	50 mm	50 kg/m <sup>3</sup>
--------------	-------	----------------------

Absorption according to EN ISO 354

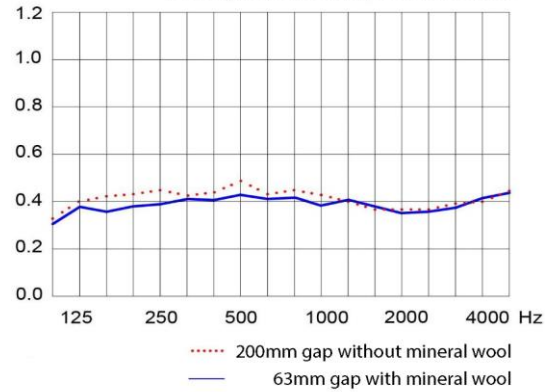

**GENERAL FEATURES:**

Materials	MDF Standart D-s2.d0 MDF Fireproof B-s2.d0
Thickness (mm)	18mm (MDF) For other materials and thicknesses, please contact with PERFOPAN
Approximate Weight	13,45 kg/m <sup>2</sup> 18mm Standart MDF      14,60 kg/m <sup>2</sup> 18mm Fireproof MDF
Finishing	Melamine      Wood Veneered      High Pressure Laminate (HPL) Varnished      Lacquered to RAL Chart

**Sizes**

Aliminium Profile	FR Class	D Class
Melamine	512x1390	512x1390
	672x1390	672x1390
	512x2780	512x2780
	672x2780	672x2780
		576x1800 576x3640
HPL	512x1390	512x1390
	672x1390	672x1390
	512x2780	512x2780
	672x2780	672x2780
		576x1800 576x3640

Aliminium Profile	FR Class	D Class
Veneered	512x1390	512x1390
	672x1390	672x1390
	512x2780	512x2780
	672x2780	672x2780
Lacquered	512x1390	512x1390
	672x1390	672x1390
	512x2780	512x2780
	672x2780	672x2780
		576x1800 576x3640